

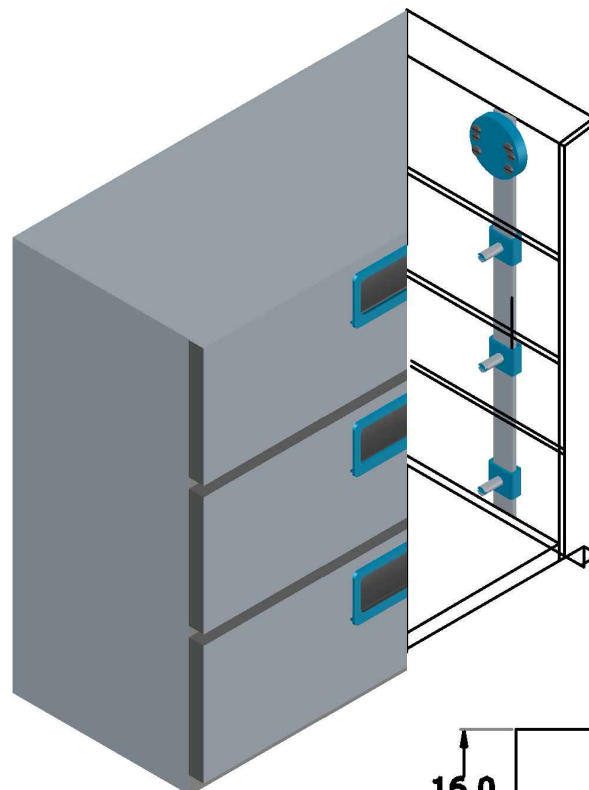

KEYMAN

ALL DIMENSIONS IN MM

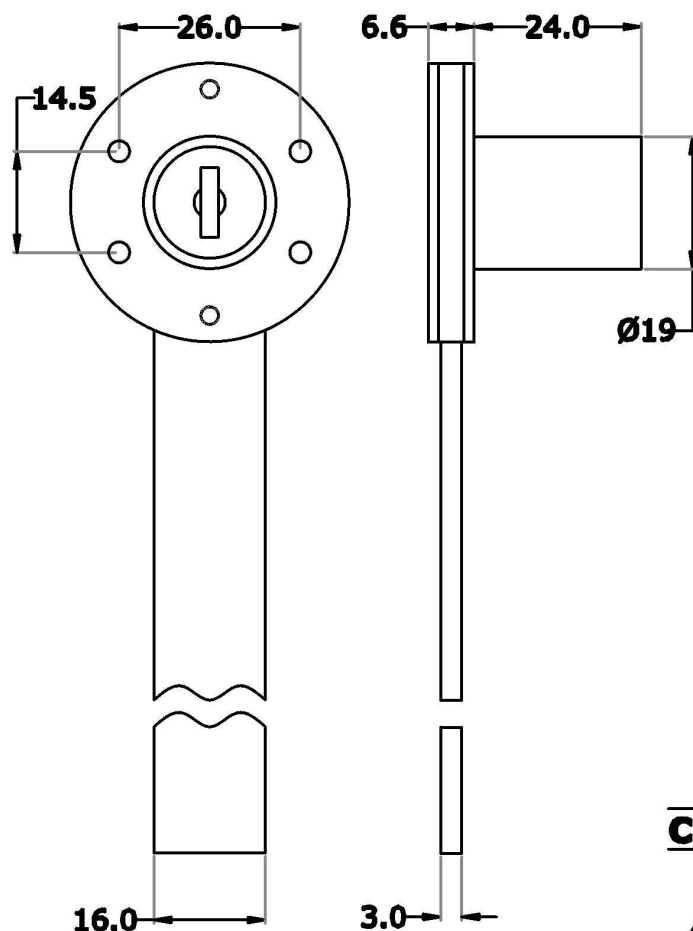

MODEL NO:	'X'
KH 8.5	3.25"
KH 8.6	9.5"
KH 8.7	11.5"
KH 8.8	19"
KH 8.9	23"

CUT -OUT

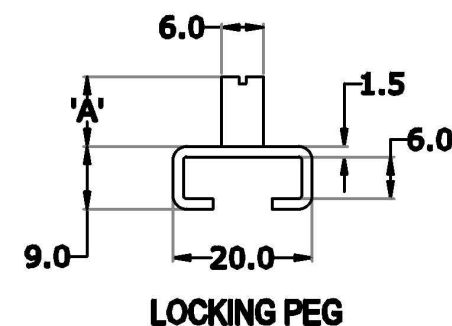
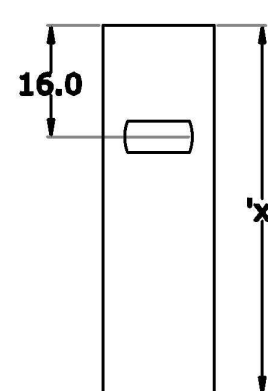
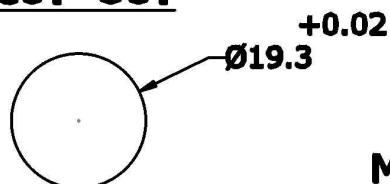

For 'A' size pls. consult page.no. HD - 04

MILD STEEL FLAT BAR

APPLICATION DRAWING FOR MODEL NO.
KH 08.5-KH 08.9 (MULTI DRAWER LOCK
SIDE MOUNTING,TOP HOLE)



ALL RIGHTS RESERVED IN FAVOUR
OF KEYMAN LOCKING DEVICES
YEAR : 2023

HD - 03